

4

3

2

1

D

D

C

C

B

B

A

A

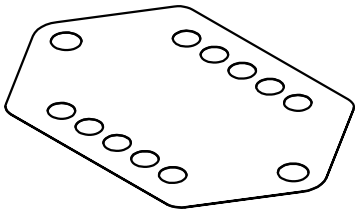
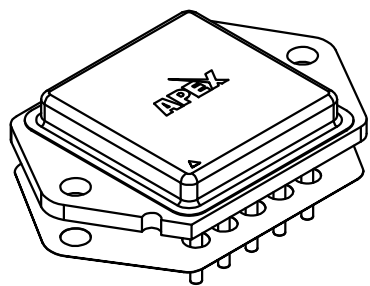
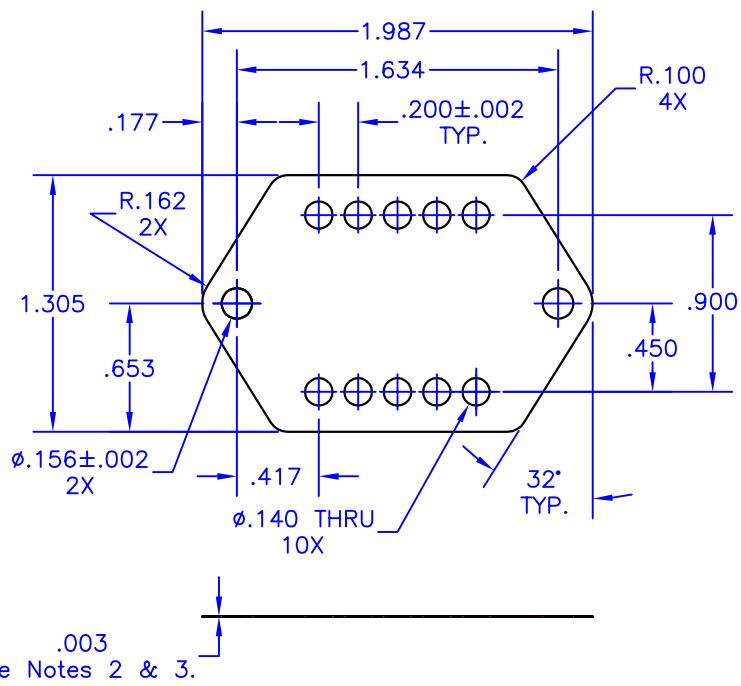

**NOTES:**

1. Unless otherwise noted, all dimensions are in inches.
2. Foil Material: .002 thick 1145 aluminum
3. Interface Material: .0005 thick phase-change thermal compound, both sides.  
Maximum shipping & storage temperature - 40°C  
Reflow temperature - 60°C  
Maximum recommended service temperature - 200°C
4. Thermal impedance: .030 °C-in<sup>2</sup>/W (.194 °C-cm<sup>2</sup>/W) @ 20psi
5. Thermal washers shall be packaged in quantities of 10 with oversize separators between them.
6. Used with 10-pin Power DIP package (Apex designator: DE).
7. Power Devices part no. AL-199-131-APX
8. Supplier is to label each plastic box with the Cirrus Logic part number.

|   |         |
|---|---------|
| TOLERANCES - UNLESS OTHERWISE SPECIFIED |         |
| .XX                                     | = ±.01  |
| .XXX                                    | = ±.005 |
| ANG.                                    | = ±.5°  |



|                                      |                     |              |               |                         |                        |
|--------------------------------------|---------------------|--------------|---------------|-------------------------|------------------------|
| TITLE<br><b>THERMAL WASHER, PDIP</b> |                     |              |               | PART NO.<br><b>TW10</b> |                        |
| SUBJECT<br>MECHANICAL DRAWING        |                     |              |               |                         |                        |
| ENG.<br>D-M                          | TECH/DRAW.<br>P.ECK | DCA<br>10455 | SH. OF<br>1 1 | FILENAME<br>TW10        | REV. DATE<br>E 16NOV10 |

4

3

2

1