

SMD Inductors(Coils) For Power Line(Wound, Magnetic Shielded)

Conformity to RoHS Directive

SLF Series SLF10165

FEATURES

- Miniature size
Mount area: 10.1×10.1mm
Height: 7mm max.
- Generic use for portable DC to DC converter line.
- High magnetic shield construction should actualize high resolution for EMC protection.
- Available for automatic mounting in tape and reel package.
- The products do not contain lead and support lead-free soldering.

APPLICATIONS

TVs, PDPs, notebook PCs, portable DVD players, terminal adapters, amusement games, LCD monitors, digital audios, etc.

SHAPES AND DIMENSIONS

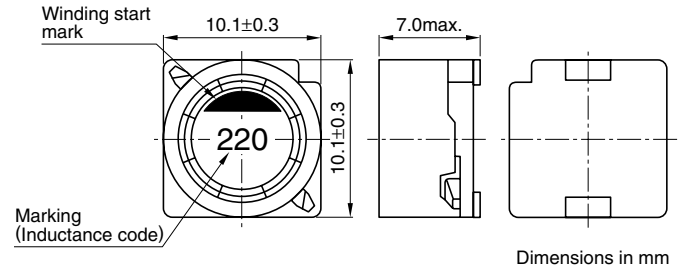

RECOMMENDED PC BOARD PATTERN

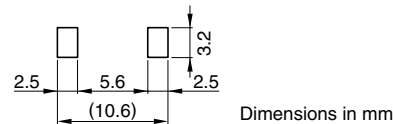

ELECTRICAL CHARACTERISTICS

Part No.	Inductance (μH)	Inductance tolerance(%)	Test frequency (kHz)	DC resistance (mΩ)	Rated current(A)*	
					Based on inductance change typ.	Based on temperature rise typ.
SLF10165T-1R5N6R83PF	1.5	±30	100	6.7±30%	10.7	6.8
SLF10165T-2R2N6R33PF	2.2	±30	100	8.4±30%	8.9	6.3
SLF10165T-3R3N5R83PF	3.3	±30	100	9.6±30%	7.8	5.8
SLF10165T-4R7N4R73PF	4.7	±30	100	11.7±30%	6.1	4.7
SLF10165T-6R8N4R33PF	6.8	±30	100	14±30%	4.6	4.3
SLF10165T-100M3R83PF	10	±20	100	18.5±20%	4.1	3.8
SLF10165T-150M3R13PF	15	±20	100	27±20%	3.1	3.1
SLF10165T-220M2R43PF	22	±20	100	44.8±20%	2.7	2.4

* Rated current: Value obtained when current flows and the temperature has risen to 30°C or when DC current flows and the nominal value of inductance has fallen by 10%, whichever is smaller.

- Operating temperature range: -40 to +105°C (Including self-temperature rise)

• Conformity to RoHS Directive: This means that, in conformity with EU Directive 2002/95/EC, lead, cadmium, mercury, hexavalent chromium, and specific bromine-based flame retardants, PBB and PBDE, have not been used, except for exempted applications.

• All specifications are subject to change without notice.