

16mm Size Motor-driven Type RK168 Series

- [Photo](#) | [Dimensions](#) | [Mounting Hole Dimensions](#) | [Standard Dimensions of Bushing and Fixing Lug](#) |
- [Style of Printed Terminal for Motor](#) | [Attached Parts](#) | [Packing Specifications](#) |
- [Soldering Conditions](#) |

PRINT

Part number		RK16812MG099
Number of resistor elements		Dual-unit
Mounting direction		Horizontal type
Fixing method of bushing		Screw
Shaft types		Flat
Length of the shaft		25mm
Total resistance		100kΩ
Resistance taper		3B
Motor print terminal		With
Motor voltage		4 to 6V DC (standard: 4.5V)
Potentiometer rotational speed		12±3 sec/300° (4.5V DC)
Maximum operating current		At rotation: 100mA/At end slip: 150mA
Operating temperature range		-10 to +70
Electrical Performance	Total resistance tolerance	±20%
	Rated power	0.05W
	Maximum operating voltage	50V AC
	Maximum attenuation	100dB min.
	Gang error	-60dB to 40dB 5dB max. -40dB to 0dB 3dB max.
	Insulation resistance	100MΩ min. 250V DC
	Voltage proof	300V AC for 1 minute
Mechanical Performance	Total rotational angle	300°±5°
	Rotational torque	10 to 40mN·m
	Stopper strength	0.9N·m

	Push-pull strength	100N max.
	Vibration	10 to 55 to 10Hz/min., the amplitude is 1.5mm for all the frequencies, in the 3 direction of X, Y and Z and for 2 hours respectively
Durability	Operating life	15,000 cycles
Minimum order unit (pcs.)	Japan	200
	Export	200

- 3D CAD (STEP) [↓](#)
- Certificate of Compliance to RoHS regulations [↓](#)

Photo



Dimensions

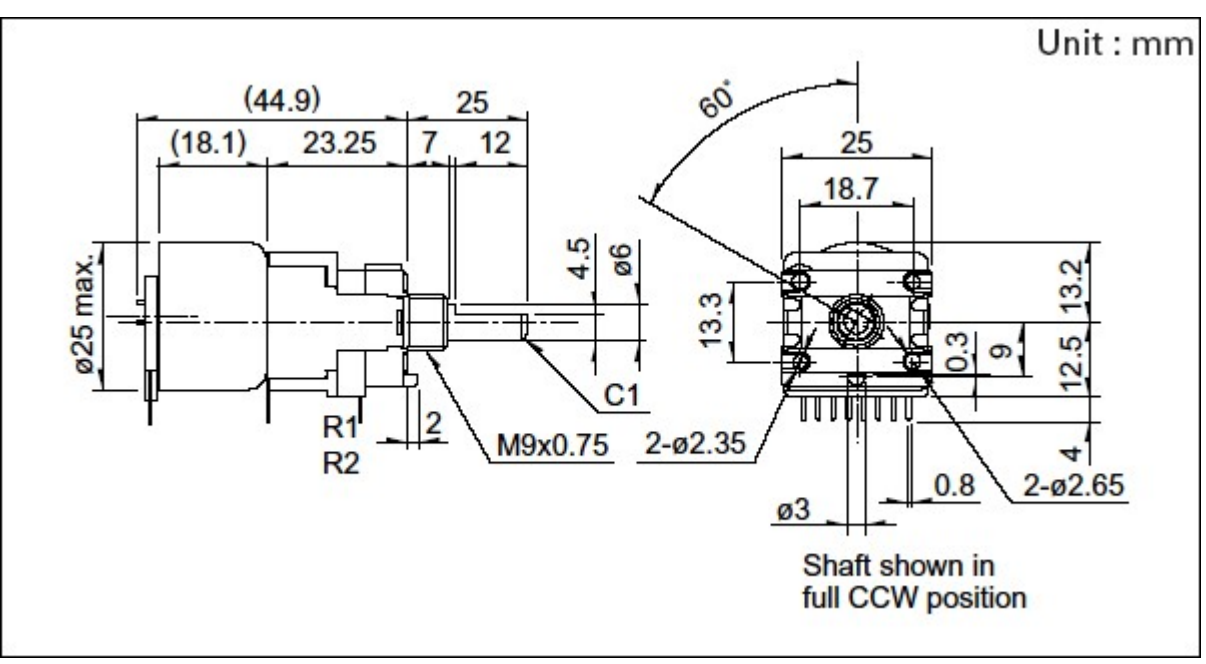

Mounting Hole Dimensions

Unit : mm

Unit : mm

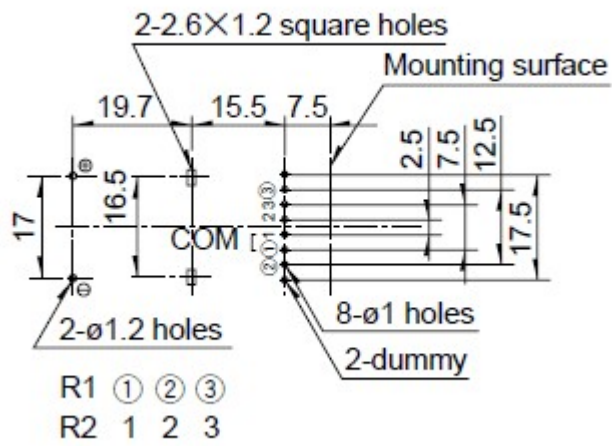

Viewed from mounting side.

Standard Dimensions of Bushing and Fixing Lug

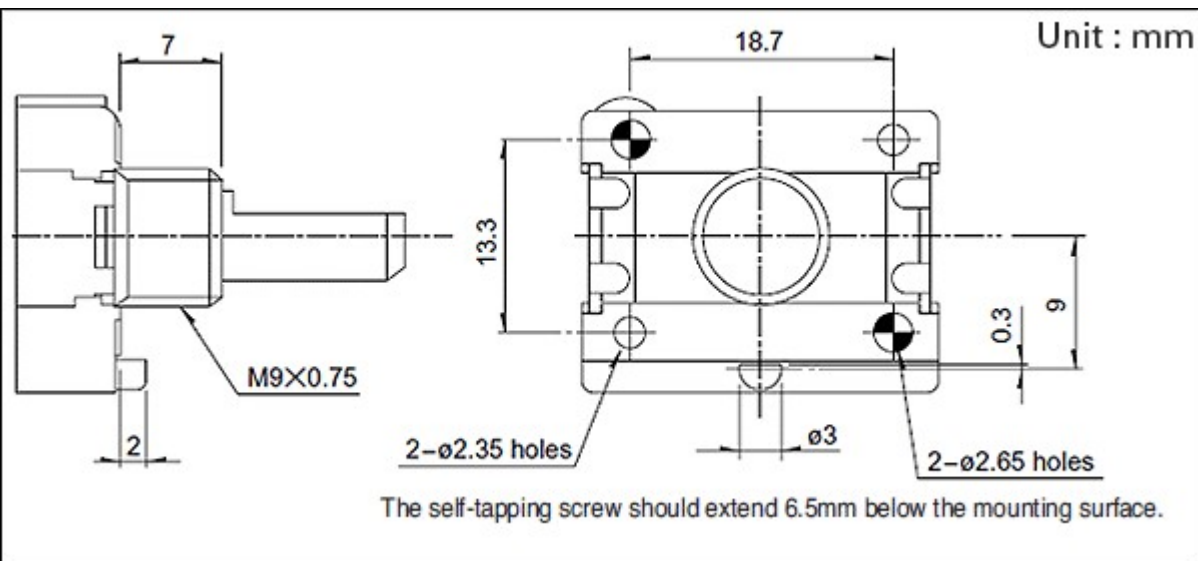

Style of Printed Terminal for Motor

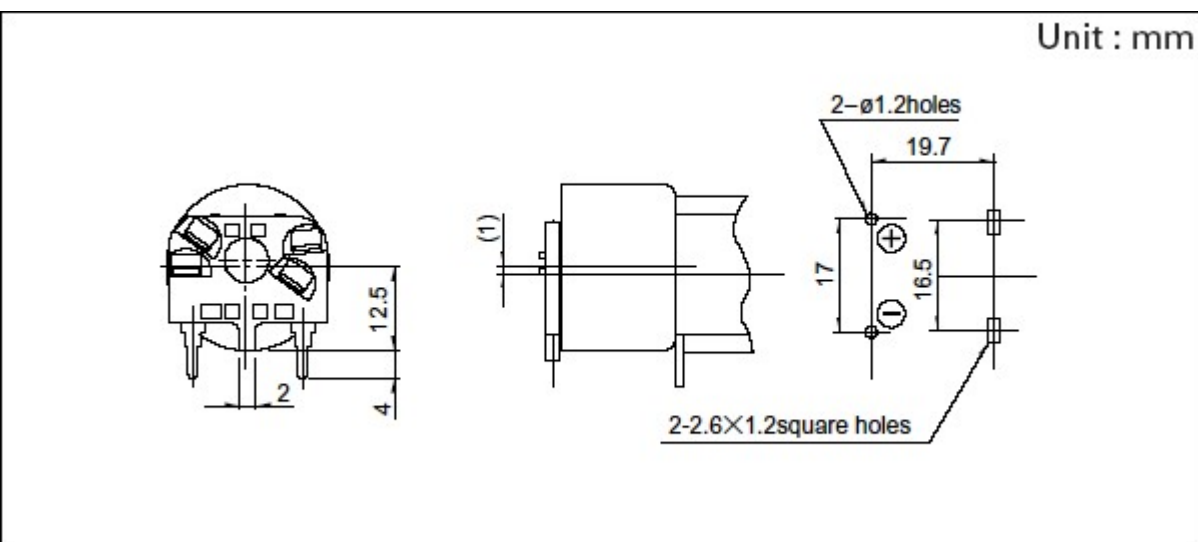

Attached Parts

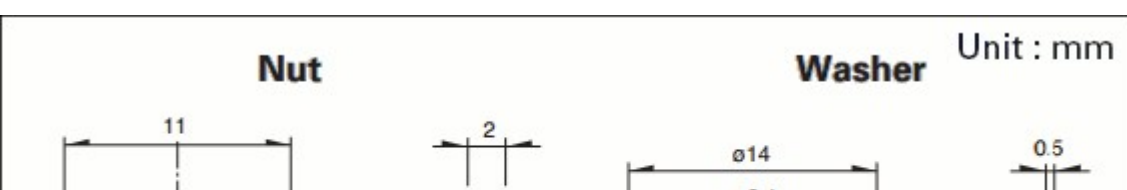

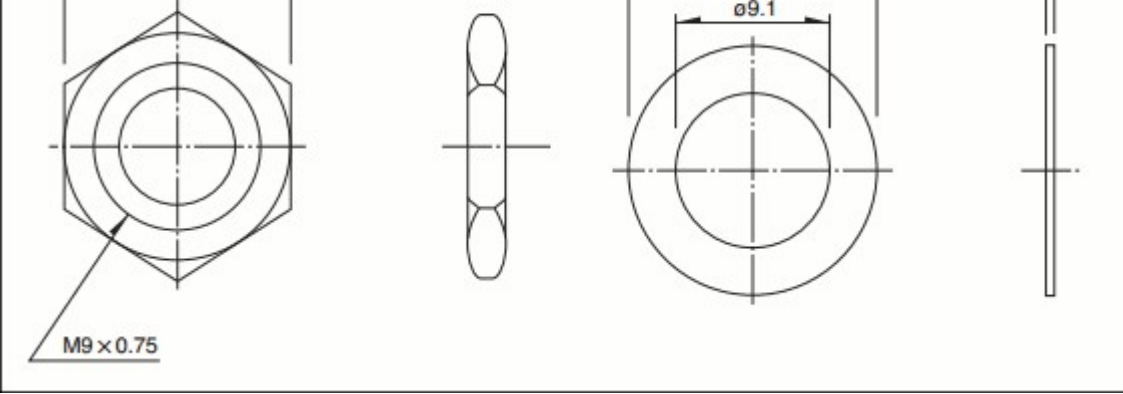

These parts are attached to the following products.

Packing Specifications

Tray

Number of packages (pcs.)	1 case / Japan	200
	1 case / export packing	200
Export package measurements (mm)	368×527×215	

Soldering Conditions

Reference for Hand Soldering

Tip temperature	300° max. (Potentiometer terminal), 350° max. (Motor terminal)
Soldering time	3s max. (Potentiometer terminal), 2s max. (Motor terminal)
No. of solders	1 time

Notes are common to this series/models.

1. This site catalog shows only outline specifications. When using the products, please obtain formal specifications for supply.
2. Please place purchase orders per minimum order unit (integer).
3. Products other than those listed in above products are also available. Please contact us for details.

Inquiries about Products

[Inquiry](#)