

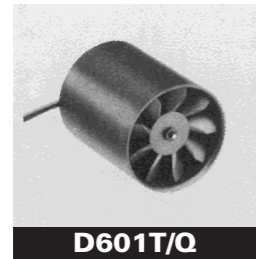

Axial Fans

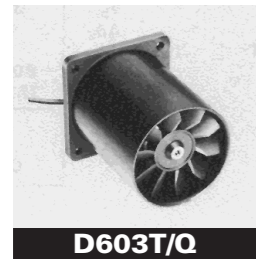

D601T/Q

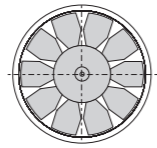
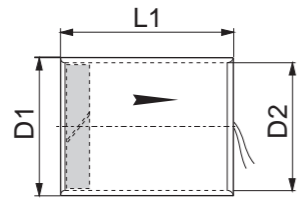

D603T/Q

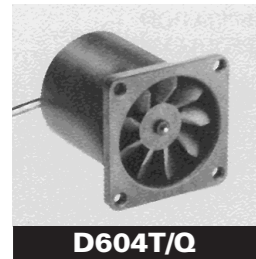
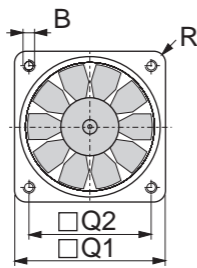
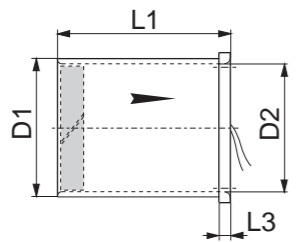

D604T/Q

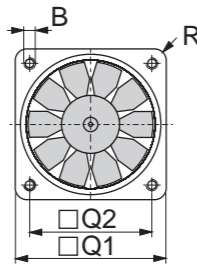
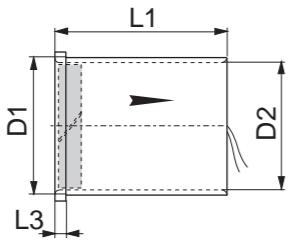

D591T/Q

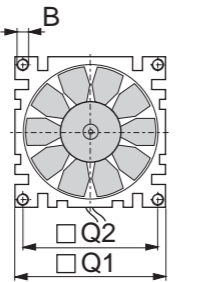
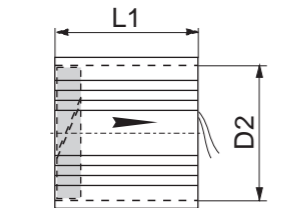

D591T, 601T, 603T, 604T 12 VDC

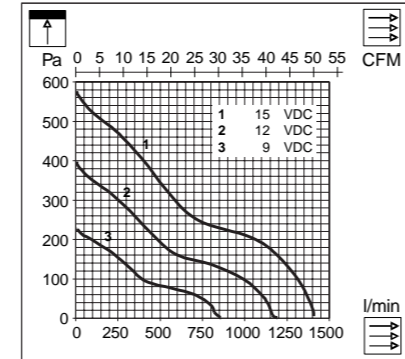

D591T, 601T, 603T, 604T 24 VDC

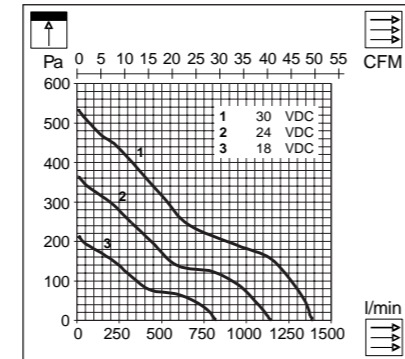

D591Q, 601Q, 603Q, 604Q 12 VDC

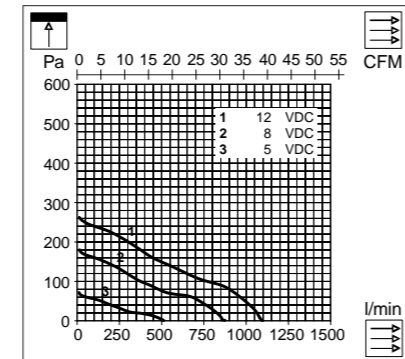

D591Q, 601Q, 603Q, 604Q 24 VDC

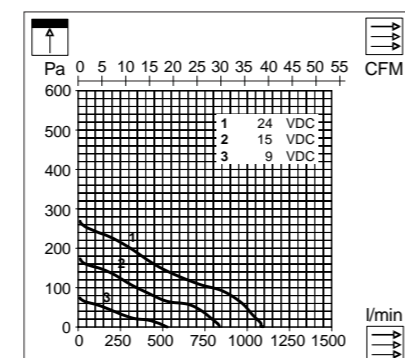

D591	mm	inch	D600	mm	inch
D1			D1	60	2.362
D2	56.5	2.224	D2	56.5	2.224
L1	60	2.362	L1	60	2.362
L2			L2		
L3			L3	4	0.157
B	M3		B	M3	
Q1	62	2.441	Q1	64	2.520
Q2	50	1.968	Q2	50	1.968
R	0.3	0.012	R	4	0.157

D600

Z:5948-201 A4 D600 0399/2000 0601/2000

Technical data

The serie D600Q is equipped with an electro-nical motor, including Micronel Asic (3 leads)
 - Long life
 - voltage range 5-30 VDC
 - tacho signal (speed indicator)
 - current limitation
 Option: 10 leads-version with further functions

Types -1 -3 -4	D591T/D601T/D603T/D604T	D591Q/D601Q/D603Q/D604Q
U U _N V	12 24	12 24
U U V	9...15 18...30	5...15 9...30
I I _N mA	557 231	635 315
I I _{max} mA	668 277	794 394
I I _{block} A	5.6 4.3	2.4 1.5
P P _N W	6.68 5.54	7.62 7.56
rpm n min ⁻¹	10650 10200	9550 9450
V V̇ l/min; CFM	1192/42.1 1143/40.4	1100/38.9 1080/38.7
p p Pa	395 366	266 268
LpA LpA dB(A)	57 56	55 56
MTTF MTTF hr	10000	++plus 40 000
T T °C/F	-20...+65 / -5...+150	-20...+65 / -5...+150
m m g/oz.	179/6.17	165/5.81
L/M L/M mm/inch	220/8.86	220/8.86
PPO PPO UL-94V-1	-	-
Aluminium Aluminium	o.k.	o.k.
CLL CLL	-	-
Ex Ex	o.k.	o.k.

Additional Functions for 10 Lead Version

- PWM (variable speed)
- PLL (constant speed)
- Low noise function
- Brake function
- Direction
- NOS

Price 1-4 pcs. _____
 Price 5-24 pcs. _____
 Delivery ARO _____