

D-Sub Connectors Straight DIP Type

17JE Series

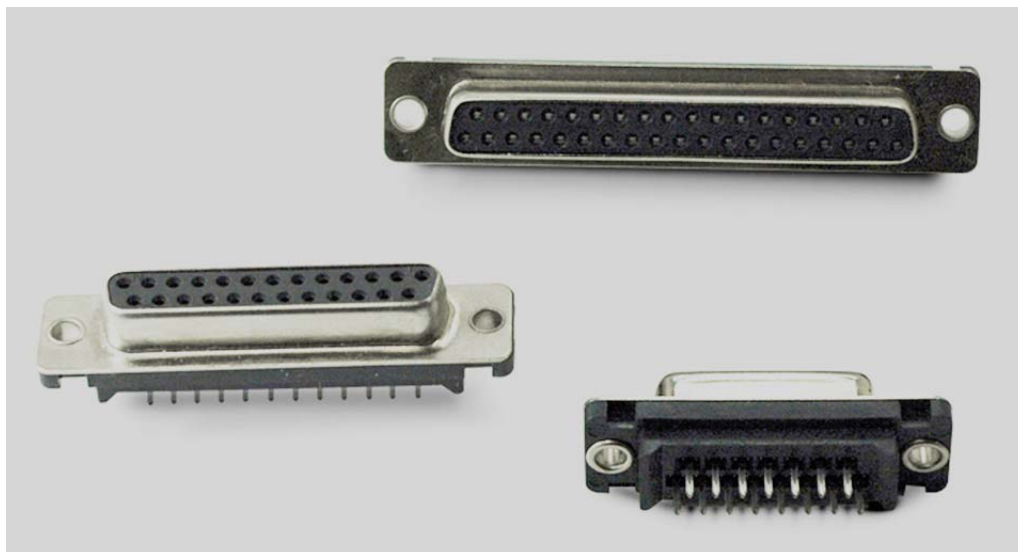

FEATURE

- DIP-type connector mounted directly on PCB. Contact tail is straight, allowing vertical mounting of connector on PCB.
- Number of contacts : 9, 15, 25 and 37
- Press-fabricated contacts. Standard surface finishing of contacts : Connections Au-plated (0.4 μ m) on Ni-substrata, tails Sn-Ag plated.
- To fasten engagement with counterpart, an engaging block and a hexagon-head nut can be attached, allowing connection of PCB's and metal shell's grounding and improving resistance against EMI.

SPECIFICATIONS

Rated Voltage	300V AC (r.m.s.)
Rated Current	5A / Contact
Dielectric Withstanding Voltage	1,000V AC (r.m.s.) / 1 minute
Insulation Resistance	1,000M Ω min. at 500V DC
Contact Resistance	15m Ω max.
Operating Temperature	- 25°C ~ + 85°C

MATERIAL / FINISH



Item	Material / Finish
Insulator	Polyamide Resin (UL94V-0) / Black
Shell	Steel / Ni Plating
Contact	Copper Alloy / Contact Area: Au(0.4 μ m) over Ni Plating Tail Area: Sn-Ag Plating over Ni Plating
Eyelet	Brass / Ni Plating

© Specifications and/or dimensions in this catalog are subject to change without notice.
Your checking the latest specifications with our drawings would be highly appreciated.

▶ Straight DIP Type Connectors

17JE-13250-37-FA

Mating Style
1 : Socket Connector

Shell Plating
3 : Nickel Plating

Number of Contact
09 : 9 Pin
15 : 15 Pin
25 : 25 Pin
37 : 37 Pin

FA: Lead Free

Contact Plating
7 : Contact Area: Au (0.4 μm) over Ni Plating
Tail Area: Sn-Ag over Ni Plating

Contact Tail Style
3 : Straight DIP Type

Key Position
0 : No Key

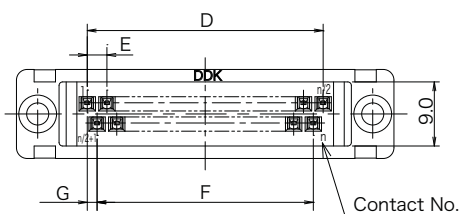
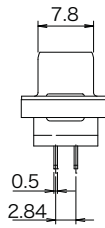
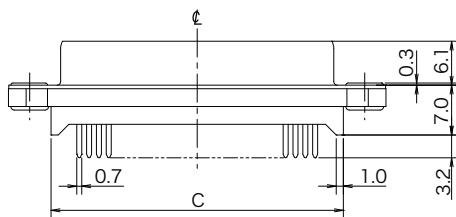
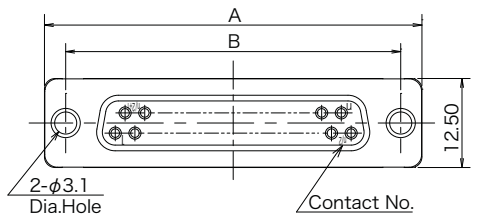

Type 3

(Rear Mounting)

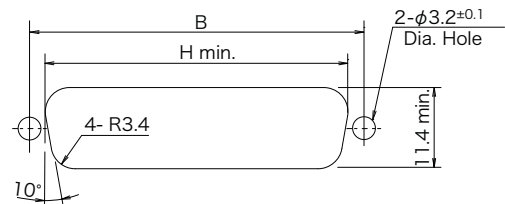

Panel Mounting Dimensions

Panel Thickness : 0.8 ~ 1.3

- Connector can be fastened on the panel.

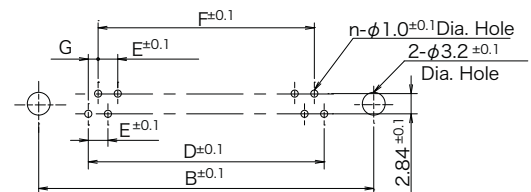

PCB Mounting Dimensions

(Applicable PCB Thickness : t = 1.6±0.19)

Part Name	Number of Contact	A	B	C	D	E	F	G	H
17JE-13090-37-FA	9	30.8	24.99	18.99	10.98	2.74	8.22	1.37	20.5
17JE-13150-37-FA	15	39.1	33.32	27.32	19.20	2.74	16.44	1.37	28.8
17JE-13250-37-FA	25	53.0	47.04	41.04	33.12	2.76	30.36	1.38	42.5
17JE-13370-37-FA	37	69.3	63.50	57.50	49.68	2.76	46.92	1.38	59.1

▶ Straight DIP Type Connectors

17JE-13250-37(D2A)-FA

Mating Style
1 : Socket Connector

Shell Plating
3 : Nickel Plating

Number of Contact
09 : 9 Pin
15 : 15 Pin
25 : 25 Pin
37 : 37 Pin

Key Position
0 : No Key

FA: Lead Free

Deviation ✖
With Square stud, Cross recessed pan head screw (Assembled)
Square stud internal thread size "L"

Contact Plating
7 : Contact Area : Au (0.4 μm) over Ni Plating
Tail Area : Sn-Ag over Ni Plating

Contact Tail Style
3 : Straight DIP Type

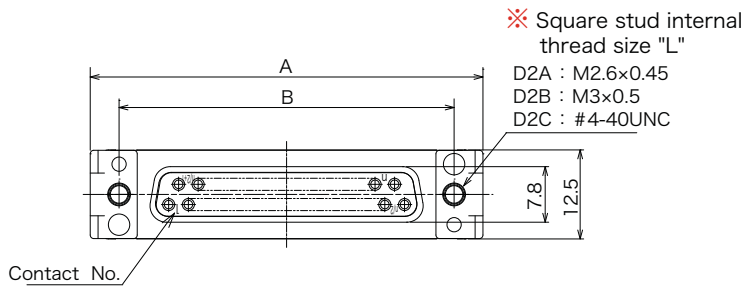

Type 1

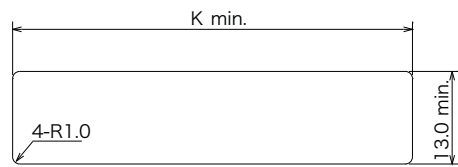

● Connector can be fastened on the panel.

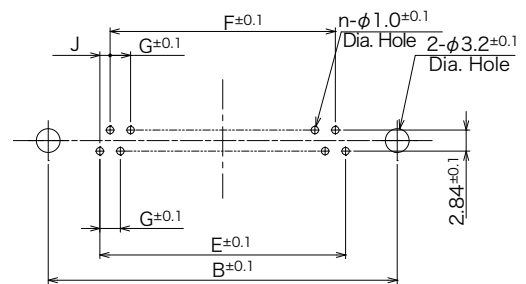
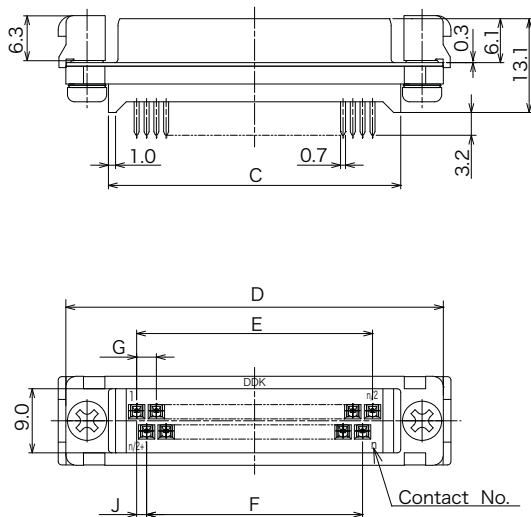

Part Name	Number of Contact	A	B	C	D	E	F	G	J	K
17JE-13090-37(D2x)-FA	09	33.09	24.99	18.99	30.80	10.98	8.22	2.74	1.37	34.09
17JE-13150-37(D2x)-FA	15	41.42	33.32	27.32	39.10	19.20	16.44	2.74	1.37	42.42
17JE-13250-37(D2x)-FA	25	55.14	47.04	41.04	53.00	33.12	30.36	2.76	1.38	56.14
17JE-13370-37(D2x)-FA	37	71.60	63.50	57.50	69.30	49.68	46.92	2.76	1.38	72.60

▶ Mounting on Panel and PCB

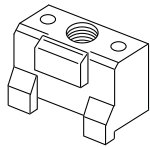

Stud
(17L-002 □)

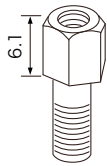
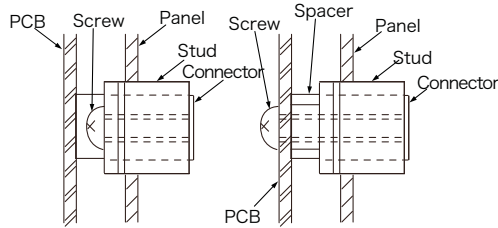

Jack Socket
(17L-003 □ 1)

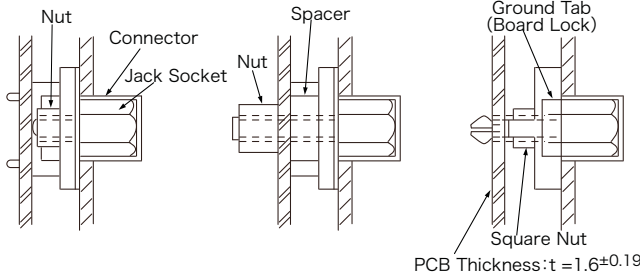

Panel Mounting Dimensions

Type 1



※ Connector can not be fastened on the panel.

Type 2

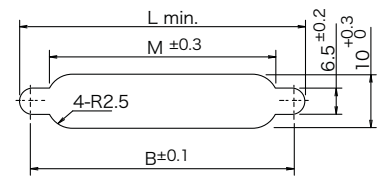

※ Connector can not be fastened on the panel.

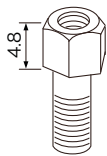

Jack Socket
(17L-003 □ 3)

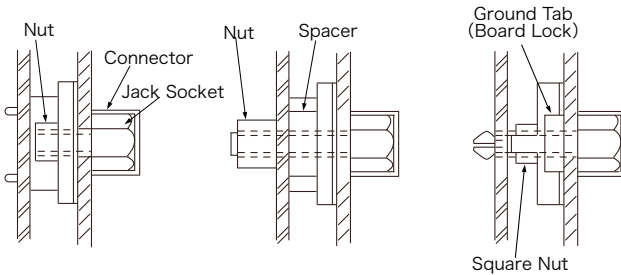

Type 3

Rear Mounting

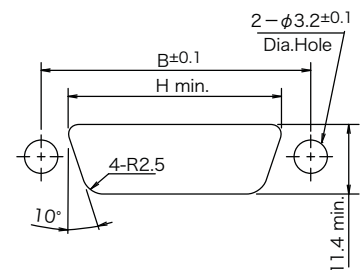

※ Connector can be fastened on the panel.
(Panel Thickness : 0.8 ~ 1.3)

□ Thread Size

A : M2.6×0.45 (Standard)

B : M3×0.5

C : #4-40UNC

Number of Contact	B	H	K	L	M
09	24.99	20.5	34.09	31.0	18.5
15	33.32	28.8	42.42	39.3	26.8
25	47.04	42.5	56.14	53.2	40.7
37	63.50	59.1	72.60	69.5	57.0

▶ 17JE(Dip) Type Mounting Accessories Deviation

※ ASSEMBLED: The mounting accessories are assembled with connector.
 ATTACHED: The mounting accessories are attached separately.

		17JE-13 □ □ 0-37-FA		
Panel Mounting Operation	Ground Tab and Spacer Part Number	None	17J-011-FA Board Lock	57D-149-6A Spacer
	Stud Jack Socket Part Number			
Type 1 Connector can not be fastened on the panel. 	17L-002 □ 	Stud 17L-002 □ and pan head screw(L=6) are ASSEMBLED. 17JE-13 □ □ 0-37(D2 □)-FA		
	Type 2 Connector can not be fastened on the panel. 	17L-003 □ 1 	Jack socket 17L-003 □ 1 and hex nut(M3) are ATTACHED. 17JE-13 □ □ 0-37(D3 □)-FA	Board Lock 17J-011-FA is fastened by jack socket 17L-003 □ 1 and square nut(M3) 17JE-13 □ □ 0-37(D23 □)-FA
17L-003 □ 2-CF 				Jack socket 17L-003 □ 2-CF and spacer 57D-149-6A and hex nut(M3) are ATTACHED. 17JE-13 □ □ 0-37(D28 □)-CA
17L-003 □ 4-CF 				Jack socket 17L-003 □ 4-CF and spacer 57D-149-6A and hex nut(M3) are ATTACHED. 17JE-13 □ □ 0-37(D16 □)-CA
Type 3 Connector can be fastened on the panel. Panel thickness : 1.3 max. 	17L-003 □ 3 	Jack socket 17L-003 □ 3 and hex nut(M3) are ASSEMBLED. 17JE-13 □ □ 0-37(D4 □)-FA		
	17L-003 □ 6-CF 			Jack socket 17L-003 □ 6-CF and spacer 57D-149-6A and hex nut(M3) are ATTACHED. 17JE-13 □ □ 0-37(D71 □)-CA Jack socket 17L-003 □ 6-CF and spacer 57D-149-6A are ATTACHED. 17JE-13 □ □ 0-37(D30 □)-CA

□ : Thread Size (Stud)



Recommended



Not available

A : M2.6×0.45 (Standard)

B : M3×0.5

C : #4-40UNC

※ Above list shows combinations of ground tab, stud and jack socket. The deviation is given in parenthesis in each sections. Regarding the detail, please contact our sales.