



Feature -
 good actuation feeling
 bi-color LED illuminated available
 long life cycles
 SPDT or DPDT, lock / non-lock function

Application -
 instrumentation
 communication equipments

► SPECIFICATIONS

SWITCH SPECIFICATIONS	
POLE - POSITION	ON - < ON > for Momentary Type , ON - ON for Self - Lock Type SPDT , DPDT
CONTACT RATING	SEE CONTACT MATERIAL
CONTACT RESISTANCE	50 mΩ MAX. (SILVER CONTACT) ; 100 mΩ MAX. (GOLD PLATING CONTACT) , 1.5 V DC ; 100 mA , by Method of Voltage DROP
INSULATION RESISTANCE	100 MΩ MIN. 500 V DC
DIELECTRIC STRENGTH	Breakdown is not Allowable ; 1000 V AC for 1 Minute
OPERATING FORCE	200 ± 100 gf (SPDT) 300 ± 150 gf (DPDT)
OPERATING LIFE	200,000 cycles (SILVER CONTACT) 200,000 cycles (GOLD PLATING CONTACT)
OPERATING TEMPERATURE RANGE	-20°C ~ 70°C
TOTAL TRAVEL	2.2 ± 0.2 mm

LED SPECIFICATIONS						
	ATTENTION	Unit	Value / LED Color			
			Red	Yellow	Green	Blue
FORWARD CURRENT	LEDs are Electrostatic Sensitive devices	If	20	20	20	20
REVERSE VOLTAGE		Vr	5.0	5.0	5.0	5.0
REVERSE CURRENT		Ir	10	10	10	10
FORWARD VOLTAGE@20mA		Vf	1.7-2.2	1.7-2.2	1.8-2.4	2.7-3.7
LUMINOUS INTENSITY@20mA		Iv	230	230	410	585

■ Physical and electrical information of LED will be provided upon customer's request on switches .

► HOW TO ORDER

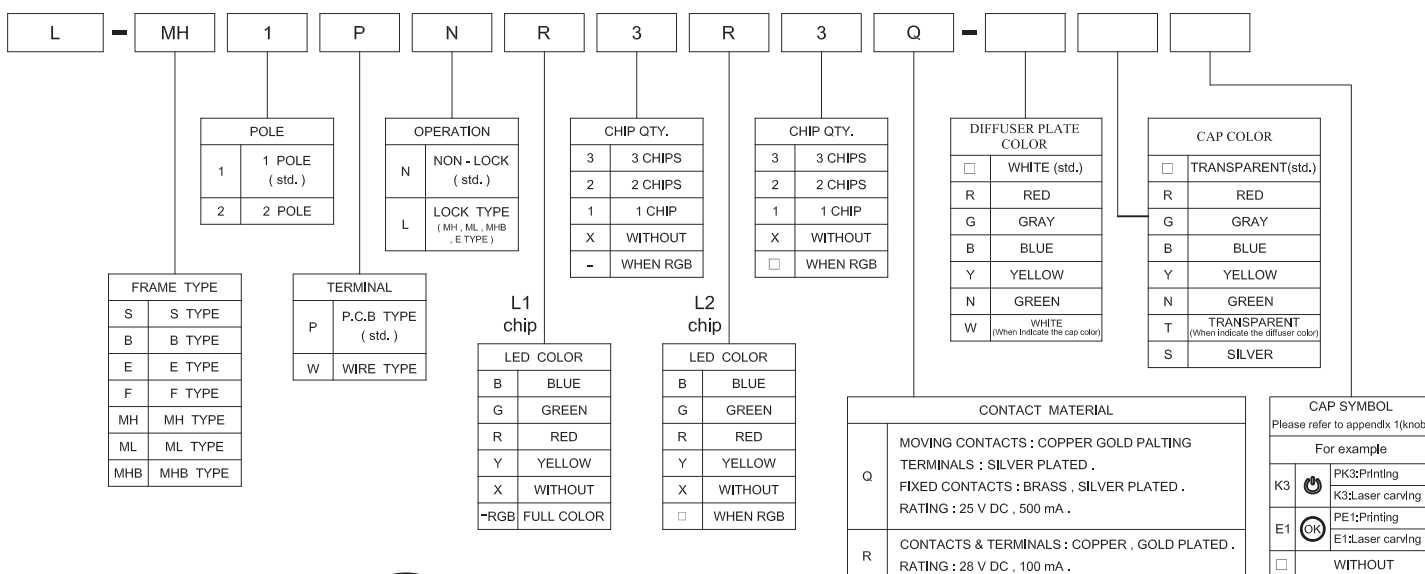

L SERIES

LED PUSH BUTTON SWITCH

► DIMENSION & FRAME TYPE

L - S1PN □□□□ Q

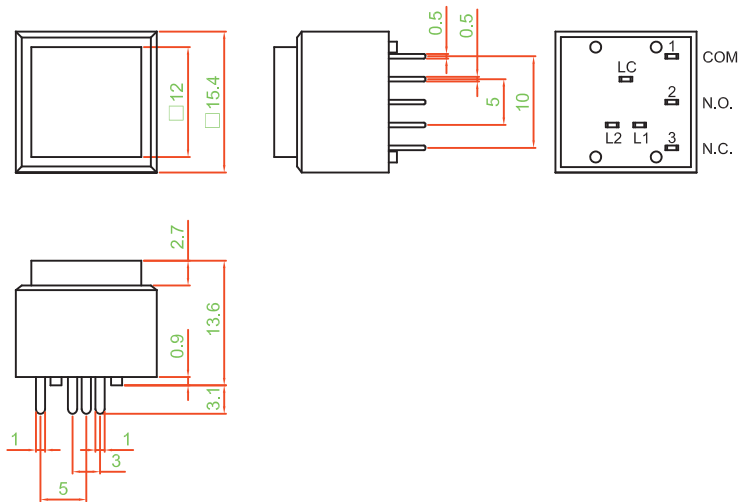

L - B1PN □□□□ Q

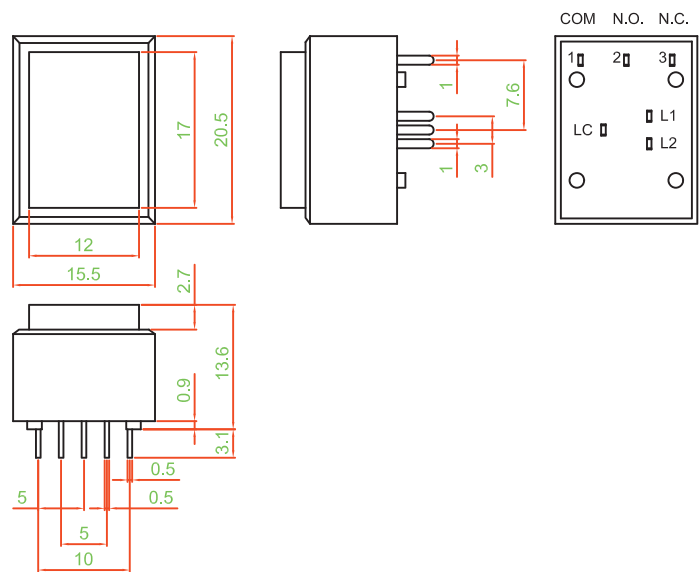

L - MH1PN □□□□ Q

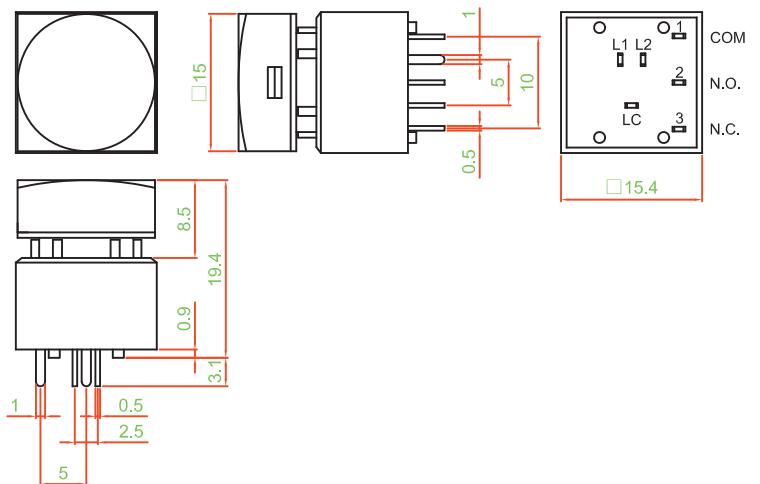

▶ DIMENSION & FRAME TYPE

L - ML1PN □□□□ Q

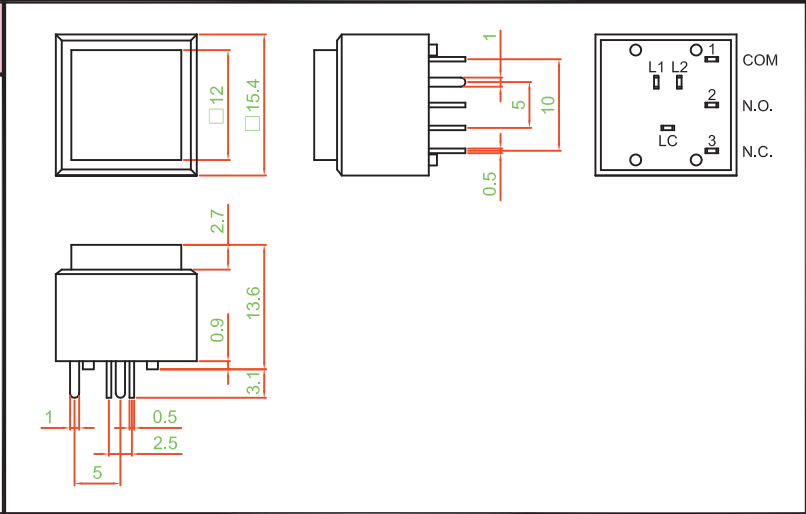

L - MH2PN-RGB-Q

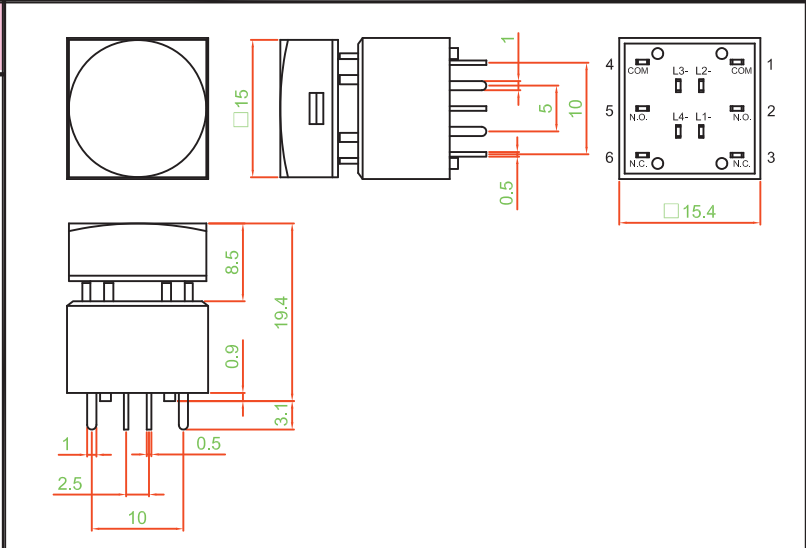

L - E1WN □□□□ Q

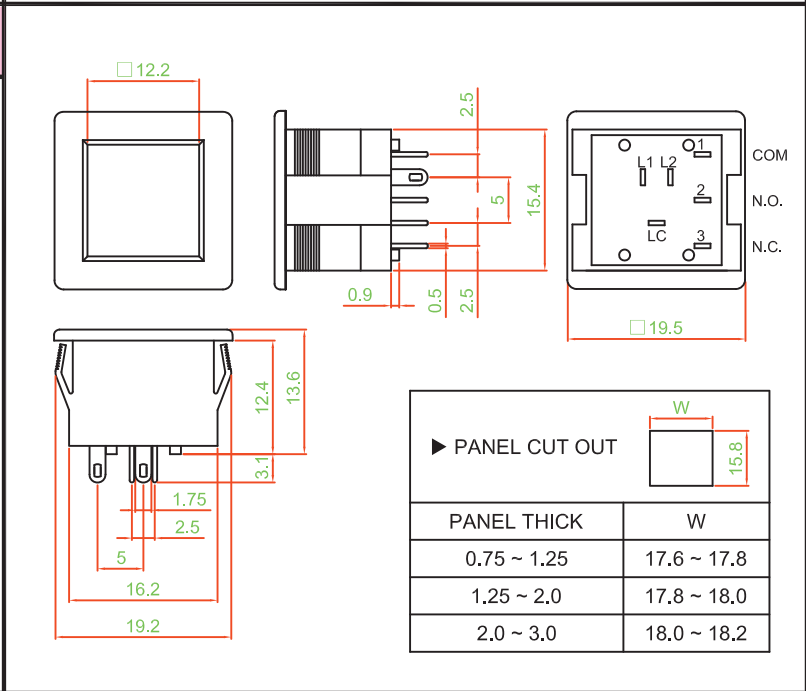

L SERIES

LED PUSH BUTTON SWITCH

► DIMENSION & FRAME TYPE

L - F1WN□□□□Q

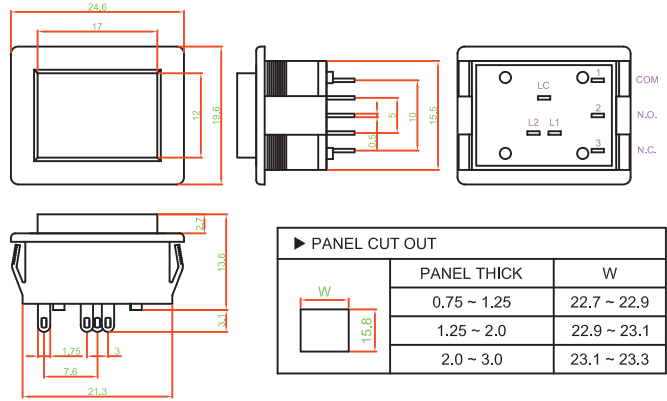

L - MHB1PN□□□□Q

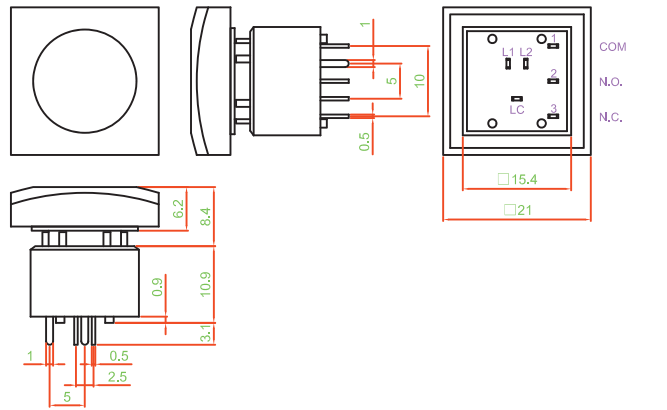

► SCHEMATIC

SWITCH

1P2T

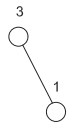

2P2T

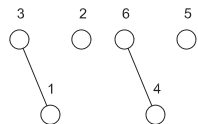

LED

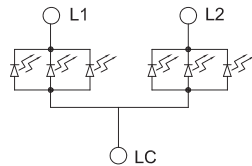

RGB

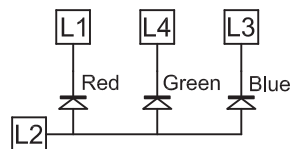

► P.C.B LAYOUT

MH.ML.MHB TYPE

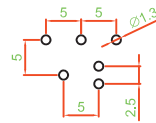

S TYPE

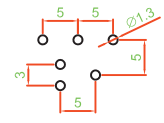

RGB TYPE

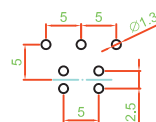

B TYPE

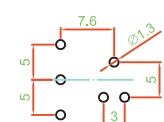

► MATERIAL

- COVER : PC
- BASE FRAME : PA + GF
- ACTUATOR : POM
- TERMINAL : Q : BRASS SILVER PLATING
R : BRASS GOLD PLATING

